



**SPORTS VILLAS**



**RISE RESORT RESIDENCES**



**SPORTS VILLAS**

Approach road between Noida, Gr Noida likely by June 30

# LOCATION

**41 Construction**  
**THE WORK HAD BEEN HALTED EARLIER DUE TO A LAND DISPUTE BETWEEN FARMERS AND THE NOIDA AUTHORITY**

The Noida authority will complete around 800 metres of an approach road to a 1.5 km long and 40m wide bridge between Greater Noida and the Noida Sector 50.

The work had been halted earlier due to a land dispute between farmers and the Noida authority. The authority has been made to clear the land for the approach road. The work will be completed by June 30.

The authority has been made to clear the land for the approach road. The work will be completed by June 30.

The authority has been made to clear the land for the approach road. The work will be completed by June 30.



SPORTS VILLAS



# SPORTS VILLAS



**RISE  
SQUARE**

**SPORTS VILLAS**

**SALES OFFICE  
RISE PROJECTS**



MEDIA IT

SHOPLEX



**SPORTS VILLAS**



-  VEHICULAR ENTRY/EXIT
-  TRAFFIC MOVEMENT
-  ADDITIONAL CAR PARKING

ENTRY / EXIT

ENTRY / EXIT



# SPORTS VILLAS

## SPORTS AMENITIES (IN SPORT'S VILLA VICINITY)

- A. Main Swimming Pool
- B. Kids Pool
- C. Volley Ball Court
- D. Tennis Court
- E. Badminton Court



SPORTS VILLAS

# OTHER AMENITIES IN RISE RESORT RESIDENCES

1. Putting Golf Course (#H1 - #H9)
2. Club
3. Cricket Ground & Plaza
4. Cricket Practice Crease
5. Basket Ball (2no.)
6. Kids' Playground & Adventure Area
7. Jogging Track
8. Indoor Sports Stadium
  - Gymnastics
  - Table Tennis
  - Squash
  - Rock Climbing
  - Multipurpose Play Field

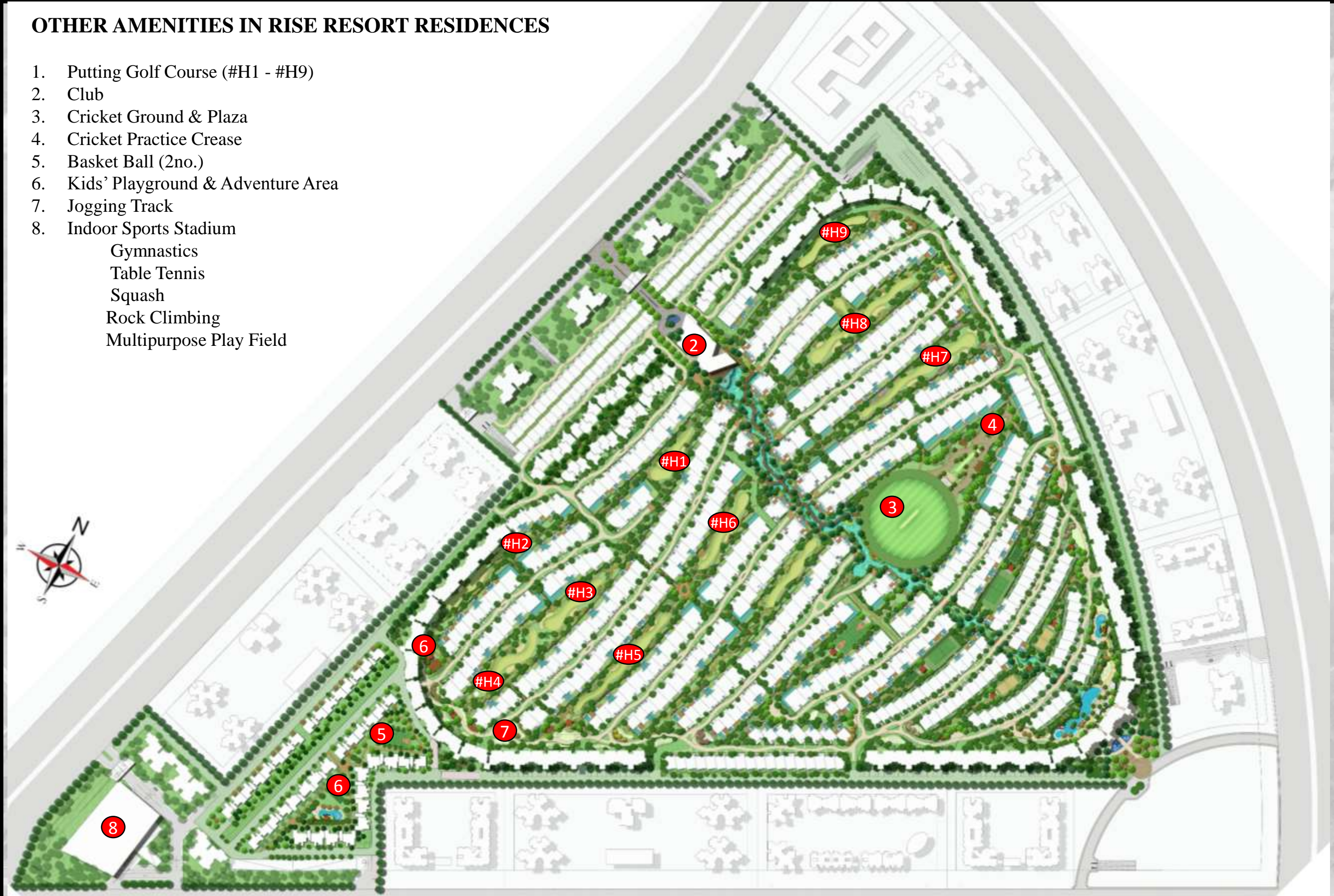

SPORTS VILLAS

# FLOOR PLANS



SPORTS VILLAS



Three Bed+ Attic / Maids Room

Plot Area : 142 Sq Yd

Saleable Area : 2495 Sqft



SPORTS VILLAS



3 BED + ATTIC / MAID'S ROOM V



SPORTS VILLAS

REAR OPEN SPACE

SWIMMING POOL + LAWN + DECK = 238 SQ.FT

3 BED + ATTIC/MAID'S ROOM (2495 SQ.FT)



GROUND FLOOR PLAN



FIRST FLOOR PLAN



TERRACE FLOOR PLAN



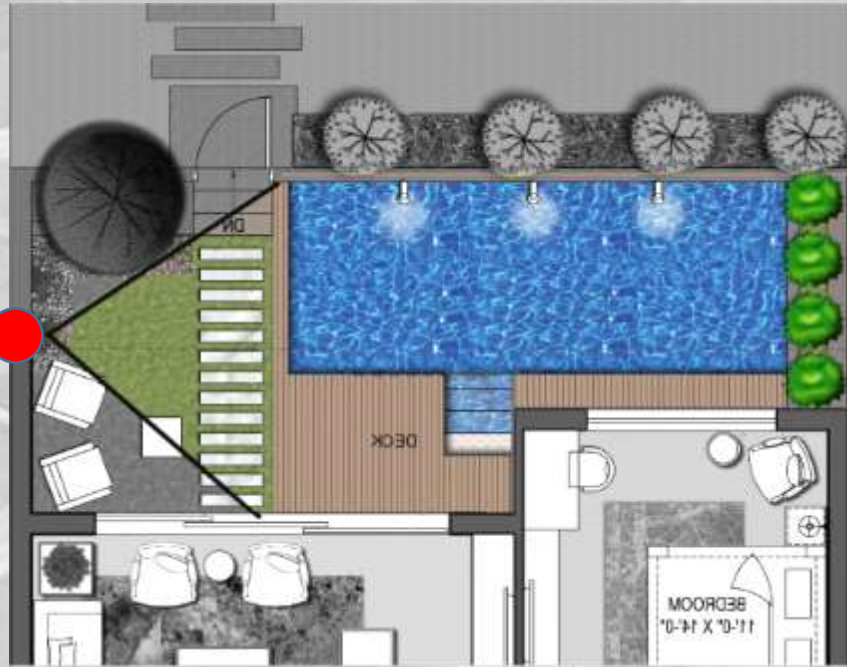

VIEW  
FROM HERE  
SWIMMING POOL

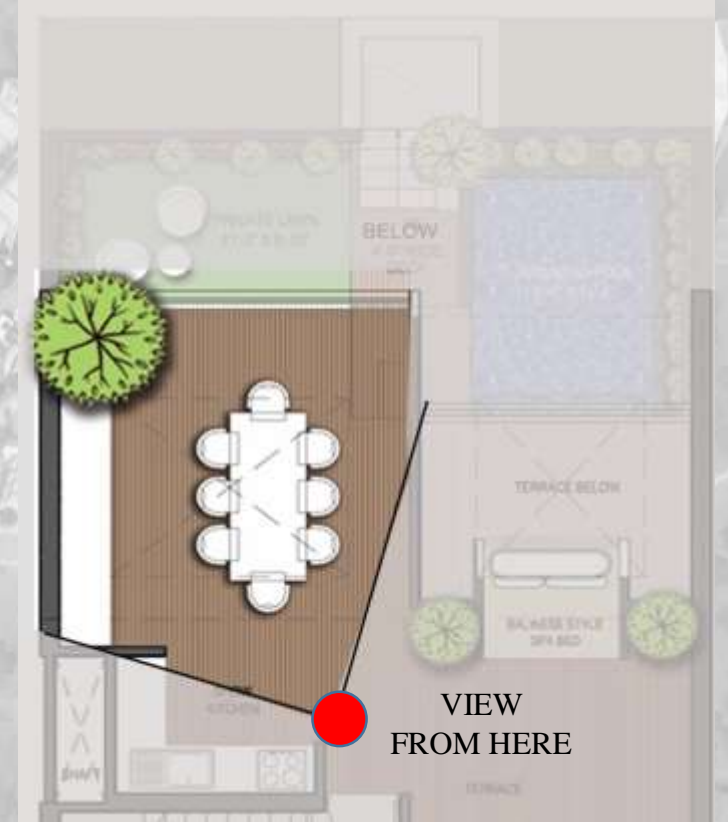

VIEW  
FROM HERE

SHOW KITCHEN AT TERRACE



SPORTS VILLAS



ELEVATION-A



ELEVATION-B



ELEVATION-C



Four Bed+ Attic / Maids Room

Plot Area : 170 Sq Yd

Saleable Area : 3070 Sqft



SPORTS VILLAS

4 BED +ATTIC/MAID'S ROOM



SPORTS VILLAS

**REAR OPEN SPACE**

**SWIMMING POOL + LAWN + DECK = 305 SQ.FT**

**4 BED + ATTIC/MAID'S ROOM(3070 SQ.FT)**

**PLOT AREA = 170 SQ.YDS.**



**GROUND FLOOR PLAN**



**FIRST FLOOR PLAN**



**TERRACE FLOOR PLAN**



4 BED +ATTIC/MAID'S ROOM



ELEVATION-A



ELEVATION-B



# Project Amenities



SPORTS VILLAS

# View of Main Swimming Pool



Belt Collins International  
Singapore . Bangkok . Bali

RISE RESORT RESIDENCES  
GREATER NOIDA, India

Landscape Concept Design  
22 June 2016



# SPORTS VILLAS

# View of Kids Swimming Pool



# View of Outdoor Play Courts



SPORTS VILLAS

# View of Cricket Stadium



# View of Stream between Villas



SPORTS VILLAS

# USPs OF SPORTS VILLAS

- SPORTS VILLAS HAVING SEPRATE ENTRY/EXIT POINTS.
- DEDICATED 10 ACRE (approx.) LAND EXCLUSIVELY FOR RISE SPORTS VILLAS i.e. **LAND SHARE APRROX 645 SQ.YD /VILLA.**
- INDIVUDUAL POOL FOR EACH VILLA WITH EXTENDED GARDEN.
- 9 MT. WIDE ABUTTING ROAD IN FRONT OF VILLAS.
- EARLY POSESSION AS HAVING G+1 STRUCTURE ONLY.
- 0 KM FROM NOIDA via NEW HINDON BRIDGE ( ALMOST OPERATIONAL).
- PROMINENT SPORTS FACILITIES i.e. TENNIS, VOLLEYBALL, BADMINTON COURT etc. IN THE VICINITY.
- ADJOINING OLYMPIC SIZE POOL & KIDS POOL.



SPORTS VILLAS

## SPECIFICATIONS FOR SPORTS VILLAS - EXCLUSIVE FINISHING

### Structure

Structure Earthquake Resistant RCC Framed Structure

### Parking

Parking One parking for each villa

### Plaster

Plaster External Plaster  
Internal Gypsum

### Drawing / Dining Space / Entrance Lobby

Flooring Vitrified Tile 1000x1000  
Wall Plastic Emulsion Paint over POP punning  
Ceiling POP / Gypsum False Ceiling

### Kitchen

Flooring Vitrified Tiles  
Kitchen Platform Superior quality Granite  
Wall Combination of Superior Quality Decorative Tiles and Plastic Emulsion Paint  
Ceiling Plastic Emulsion Paint over POP punning  
Fittings & Fixtures SS Sink, chromium Plated Fittings, Exhaust Fan & Hot Water Supply

### Master Bed room

Flooring Laminated Wooden Flooring  
Wall Plastic Emulsion Paint over POP punning  
Ceiling POP / Gypsum False Ceiling

### Master Toilet

Flooring Anti Skid Tiles  
Walls Combination of Decorative Tiles and Acrylic Emulsion Paint  
Ceiling POP / Gypsum False Ceiling  
Sanitary ware Chinaware of Hindware/Jaguar or equivalent  
Counter Superior quality natural stone like granite/marble as per design  
Fittings & Fixtures CP Fittings of Hindware/Jaguar or equivalent

### Other Bed rooms

Flooring Vitrified Tiles  
Wall Plastic Emulsion Paint over POP punning  
Ceiling POP / Gypsum False Ceiling

### Toilets / Powder Room

Flooring Anti Skid Tiles  
Walls Combination of Decorative Tiles and Acrylic Emulsion Paint  
Ceiling POP / Gypsum False Ceiling  
Sanitary ware Chinaware of Hindware/Jaguar or Equivalent  
Counter Superior quality natural stone like granite/marble as per design  
Fittings & Fixtures CP Fittings of Hindware/Jaguar or Equivalent

### Balcony / Verandah

Flooring Anti- Skid Ceramic tiles.  
Wall Exterior Anti Fungal Paint of Good Quality.  
Railing Combination of parapet wall and Duco Painted MS railing as per façade design / Elevation.

### Door / Windows

Main Door Polished Hardwood Frames(Marandi/SAL or equivalent) with Skin molded Doors  
Internal Doors Polished Hardwood Frames(Marandi/SAL or equivalent) with Skin molded Doors  
Toilet Doors Polished Hardwood Frames(Marandi/SAL or equivalent) with Skin molded Doors  
External Doors and Windows Imported UPVC Doors and Windows  
St. Room 7' high Hardwood Frames(Maranti or equivalent) with Laminated Doors.

### Staircase

Flooring Treads & Risers of Marble / Granite  
Railing M.S. Railing

### Servant room / Utility

Flooring Ceramic Tiles or equivalent  
Wall Oil bound distemper Paint  
Ceiling Oil bound distemper Paint  
Toilet Anti skid Ceramic Tiles

### Terrace

Flooring Anti- Skid Ceramic tiles.  
Parapet Wall Exterior Anti Fungal Paint of Good Quality.  
Railing Combination of parapet wall and Duco Painted MS railing as per design  
Additional feature Balinese type spa / day bed with mattress

Powder room and utility for convenience  
Outdoor platform with sink which can be used as Live kitchen counter  
Servant/utility area Servant room with toilet through utility area

### Rear Garden

Anti skid Ceramic/Vitrified Tiles on Deck  
Lawn with 5 fruits tree & 5 Herbs

### Swimming Pool (optional)

Pool wall and floor Glass/Handmade/Mosaic tiles  
Filtration Filtration plant room and electrical panel.  
Lights RGB  
Additional feature SS ladder/Steps as per design

### Other important Specifications

Air Conditioning Provision for High wall Air Conditioning by providing Copper and drain pipes of Family Lounge / Master bedrooms / Bedrooms / Multipurpose Hall  
E Security Secured Gated Community  
Power Backup Minimum DG power backup: 7 KVA for all villa  
Plumbing CPVC & UPVC piping for water supply inside the toilet & kitchen and vertical down takes  
Electrical Modular switches, Copper wiring with MCB's & Light Fittings in false ceiling only as per Design  
Water Supply 24 Hr uninterrupted water supply.



# SPORTS VILLAS



## SPECIFICATION FOR BARE SHELL

### Structure

Structure Earthquake Resistant RCC Framed Structure

### Parking

Parking One parking for each villa

### Entrance Lobby / Drawing / Dining Space /Bed rooms

Internal & external brickwork

### Openings for Door / Windows

Openings for door & windows in internal/external walls

### Balcony /Verandah

Combination of parapet wall & MS railing as per façade & elevation design(without plater)

### Rear garden

Lawn with 5 fruits tree & 5 Herbs

### Terrace

Parapet Wall Brickwork (without plaster)

Railing Combination of parapet wall & MS railing as per façade & elevation design(without plater)

Additional feature Semi covered terrace(pergola)to increase its weather usability and privacy of terrace

Balinese style SPA/day bed(without stone & mattress)

Powder room & Store room for convenience

### Other important Specifications

E Security Secured Gated Community

Power Backup Minimum DG Power backup:4 KVA

Electrical Electrical conduiting in slab only

Water Supply Water supply till one point at ground floor

THANK YOU



SPORTS VILLAS